

PRAIRIE RANCH



Starting From 3,300 SF | 3-4 Bedrooms / 4.1 Baths | 4-Car Garage

The Prairie Ranch runs true to its name and while it pays homage to the surrounding environment, its sleek contemporary exterior is inviting and warm. Inside the spacious foyer opens to a grand kitchen, dining room and great room with large door walls and windows that allow sunlight to fill the space. Granite countertops span the length of the kitchen and on the massive island, a large walk-in pantry makes for ample storage. The library is welcoming with double doors and is perfect for a home office or den. The owner's suite is located in a private wing, large windows and a spa-like bathroom with double vanities, a soaking tub and shower create a perfect retreat. Two en suite guest bedrooms in the opposite wing make this home perfect for families. This grand home also features an optional second floor bonus/bedroom, complete with full size bath and walk-in closet.

MOCERI®

Moceri.com

PRAIRIE RANCH

Starting From 3,300 SF | 3-4 Bedrooms / 4.1 Baths | 4-Car Garage



FIRST LEVEL

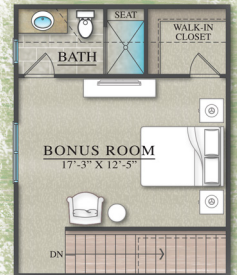

OPTIONAL SECOND LEVEL

MOCERI

Moceri.com

Dominick Tringali
ARCHITECTURAL COLLECTION

*Shown with optional features. We reserve the right to modify features, price, specifications, and/or change or discontinue floor plans without notice or obligation. Photos represent similar plan and finishes. Floor plan dimensions are approximate. All information provided herein is subject to change at developer's sole discretion. © 2021 Moceri. All Rights Reserved. 052721

